

UB-288

2009.09.11

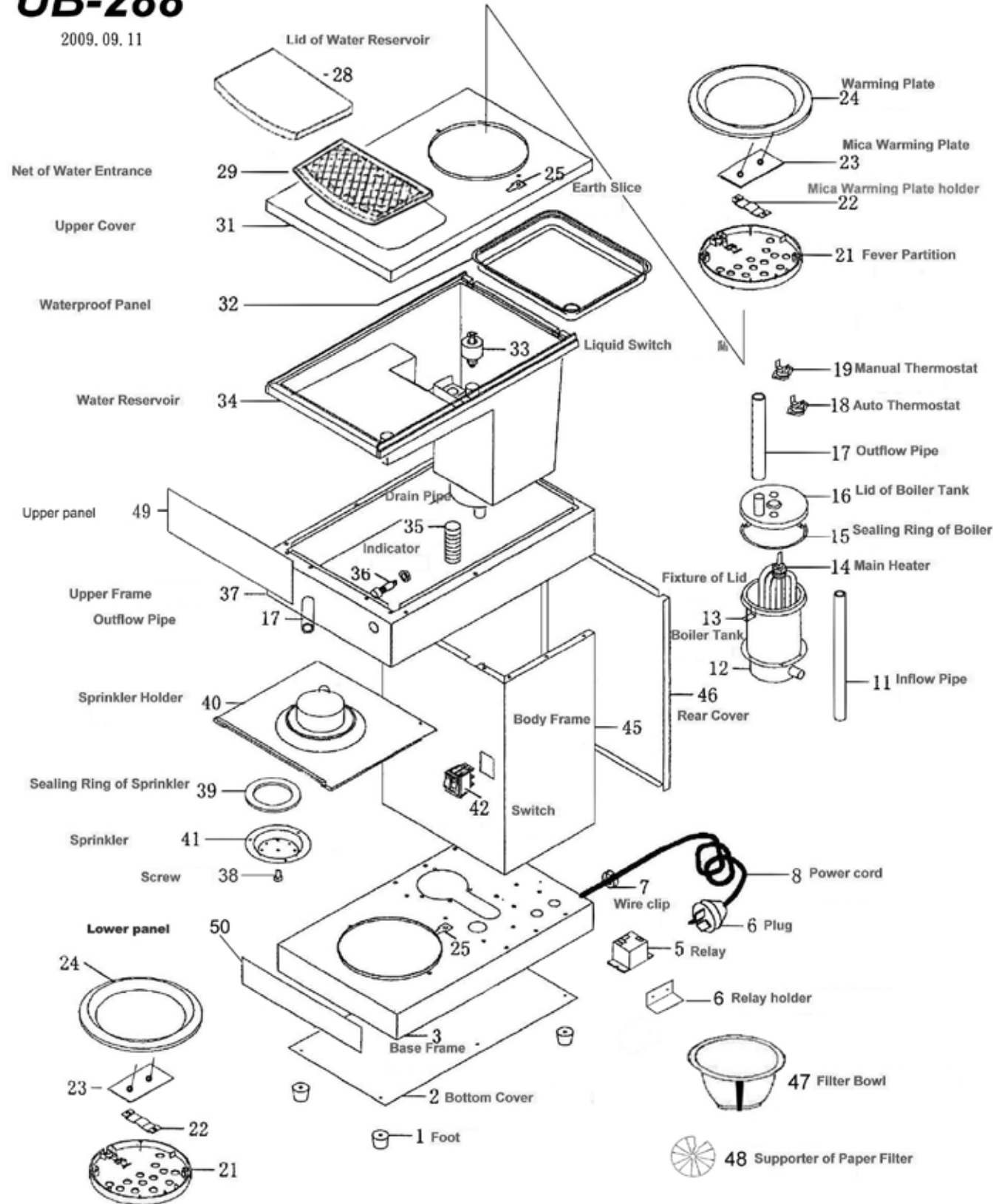

STOCK CODE	DESCRIPTION	DRAWING REF
XCMC6001	C/MACH ARO/AVENIA-RUBBER FOOT(SET OF4)(UB288)	1
XCMC6004	C/MACH ARO/AVENIA-RELAY(UB288)	5
XCMC6015	C/MACH ARO/AVENIA-MAIN ELEMENT(UB288)	14
XCMC6014	C/MACH ARO/AVENIA-SEALING RING OF BOILER(UB288)	15
XCMC6017	C/MACH ARO/AVENIA-OVERFLOW PIPE(UB288)	17
XCMC6018-1	C/MACH ARO/AVENIA-AUTO THERMOSTAT	18
XCMC6023	C/MACH ARO/AVENIA-MICA WARMING PLATE(UB288)	23
XCMC6019	C/MACH ARO/AVENIA-LID OF WATER ENTRANCE(UB288)	28
XCMC6020	C/MACH ARO/AVENIA-WATER ENTRANCE(UB288)	29
XCMC6024	C/MACH ARO/AVENIA-FLOAT SWITCH(UB288)	33
XCMC6026	C/MACH ARO/AVENIA-DRAIN PIPE(UB288)	35
XCMC6041	C/MACH ARO/AVENIA-SEALING RING OF SPRINKLER(UB288)	39
XCMC6042	C/MACH ARO/AVENIA-SPRINKLER HEAD(UB288)	41
XCMC6033	C/MACH ARO/AVENIA-SWITCH(UB288)	42
XCMC9024	C/MACH [CAFERINA] - FILTER PAN(UB288)	47
XCMC6094	C/MACH ARO/AVENIA- SML ROUND FLAT SPRING FOR UB-288	48
XCMC9025	C/MACH [CAFERINA] - LARGE FILTER PAN SPRING	48
XCMC6018-2	C/MACH ARO/AVENIA-MANUAL THERMOSTAT	19